



Ultimate Inline Patio Doors Technical Specification

JohnFREDERICKS

MANUFACTURERS OF

*the*ultimate[®]
collection

PVC-u Profile

- Halo bevelled or ovolo profile sash
- Outer frame 88mm rebated to 71mm depth x 58mm high
- Welded outer frame and sashes
- Optional mechanical kit-form outer frame
- Steel reinforced to manufacturers specification
- Mitred internal bevelled or ovolo beads
- Optional 25mm aluminium low threshold

Colours

- Scan QR code to see our extensive colour range



Handles

- D-shaped pull handles incorporating lever to operate lock
- Standard – White
- Optional handles available in – Black, Chrome, Gold, Graphite, Bronze, Antique Black, Satin
- Optional blank handle if required

Standard Yale multipoint lock

- 6 x high performance bi-parting hooks (optional 8 point lock)
- Yale 3 star cylinder
- Anti-lift device
- Aluminium inter-lock including woolpile
- Stainless steel adjustable rollers

Glass Unit Options

- Standard 28mm double glazed toughened glass
- Optional 32mm triple glazed toughened glass (bevelled bead only)
- Black warm edge spacer bar
- Optional White or Grey warm edge spacer bar

Glazing Options

- Wide range of patterned / privacy and leaded / Georgian glass designs available, tailored to suit your specific requirements

Accreditations

- PAS24 optional upgrade

ULTIMATE INLINE PATIO DOORS - TYPICAL SECTIONS

Doors can be 2,3 or 4 panel

Fully bevelled or ovolo profile | All measurements in mm

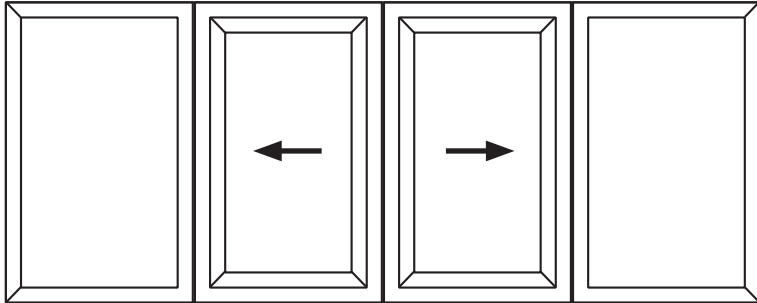

4 PANEL HORIZONTAL IN-LINE PATIO

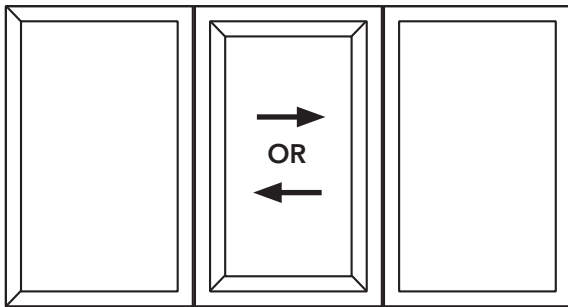

3 PANEL HORIZONTAL IN-LINE PATIO

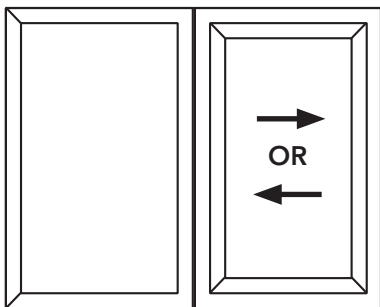

2 PANEL HORIZONTAL IN-LINE PATIO

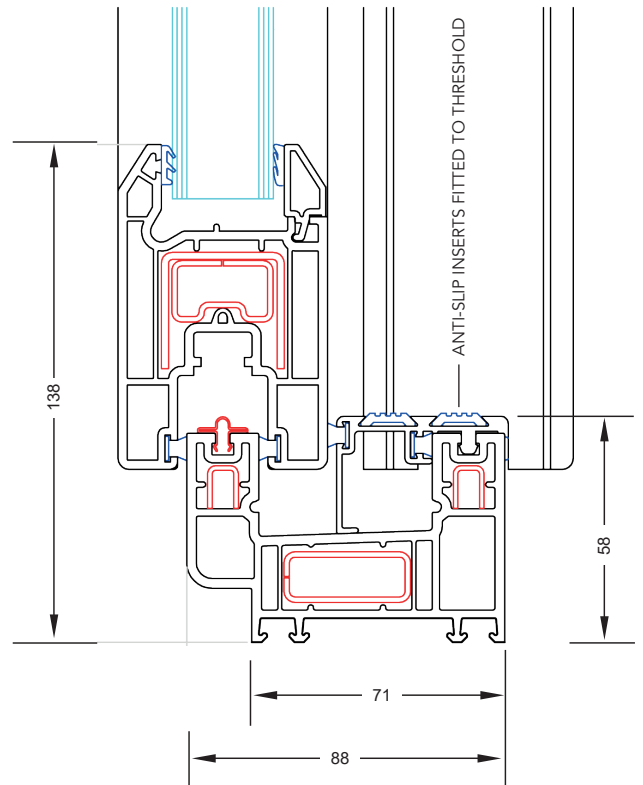
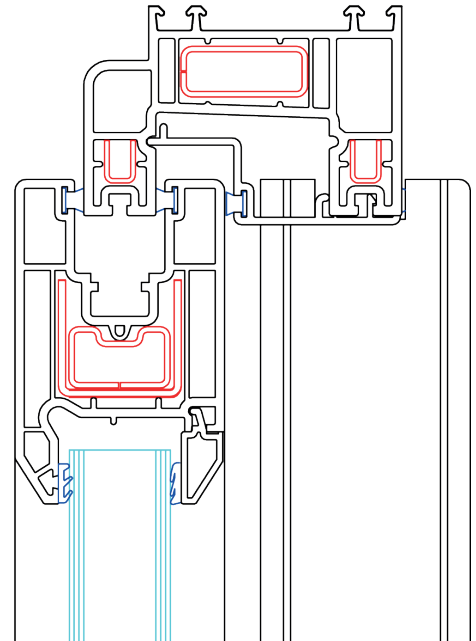

Minimum and Maximum Patio Door Sizes

Style	Min Width	Min Height	Max Width	Max Height
2 Panel In-line	1600mm	2000mm	3000mm	2360mm
3 Panel In-line	2400mm	2000mm	4000mm	2360mm
4 Panel In-line	3000mm	2000mm	5000mm	2360mm

Note:- Doors can be sited on 30mm Halo cills as shown on entrance door data cards.